

**Dated 05 April 2022**

**TEST VALLEY BOROUGH COUNCIL**

**Town and Country Planning Act 1990**

**TREE PRESERVATION ORDER  
TPO.TVBC.1245**

**Land at Hill View, Romsey Road, Kings Somborne, Stockbridge, SO20 6PR**

**Head of Legal & Democratic Services  
Test Valley Borough Council  
Beech Hurst  
Weyhill Road  
Andover  
Hampshire  
SP10 3AJ**

TOWN AND COUNTRY PLANNING (TREE PRESERVATION)(ENGLAND)

REGULATIONS 2012

TREE PRESERVATION ORDER

TOWN AND COUNTRY PLANNING ACT 1990

THE BOROUGH COUNCIL OF TEST VALLEY TREE PRESERVATION ORDER  
TPO.TVBC.1245

LAND AT HILL VIEW, ROMSEY ROAD, KINGS SOMBORNE, STOCKBRIDGE, SO20 6PR

The Borough Council of Test Valley, in exercise of the powers conferred on them by section 198 of the Town and Country Planning Act 1990 hereby make the following Order-

**Citation**

1. This Order may be cited as the Borough of Test Valley Tree Preservation Order TPO.TVBC.1245

**Interpretation**

2. (1) In this Order "the authority" means the Borough Council of Test Valley

(2) In this Order any reference to a numbered section is a reference to the section so numbered in the Town and Country Planning Act 1990 and any reference to a numbered regulation is a reference to the regulation in the Town and Country Planning (Tree Preservation) (England) Regulations 2012.

**Effect**

3. (1) Subject to article 4, this Order takes effect provisionally on the date on which it is made.

(2) Without prejudice to subsection (7) of section 198 (power to make tree preservation orders) or subsection (1) of section 200 (tree preservation orders: Forestry Commissioners), and subject to the exceptions in regulation 14, no person shall-

(a) cut down, top, lop, uproot, wilfully damage or wilfully destroy; or

(b) cause or permit the cutting down, topping, lopping, uprooting, wilful damage or wilful destruction of,

any tree specified in the Schedule to this Order except with the written consent of the authority in accordance with regulations 16 and 17, or of the Secretary of State in accordance with regulation 23, and, where such consent is given subject to conditions, in accordance with those conditions.

**Application to trees to be planted pursuant to a condition**

4. In relation to any tree identified in the first column of the Schedule by the letter "C", being a tree to be planted pursuant to a condition imposed under paragraph (a) of section 197 (planning permission to include appropriate provision for preservation and planting of trees), this Order takes effect as from the time when the tree is planted.

## SCHEDULE 1

### SPECIFICATION OF TREES

#### Trees specified individually (encircled in black on the map)

Reference on map	Description	Situation
T1	Silver Birch	Close to the north western boundary of Hill View, Romsey Road, Kings Somborne, Stockbridge, SO20 6PR
T2	Walnut	

#### Trees specified by reference to an area (within a dotted black line on the map)

Reference on map	Description	Situation
None		

#### Groups of trees (within a broken black line on the map)

Reference on map	Description	Situation
None		

#### Woodlands (within a continuous black line on the map)

Reference on map	Description	Situation
None		

The Common Seal of Test Valley Borough Council  
was hereto affixed this 5th day of March 2022

)  
)  
)

*Karen Dunbar*  
.....

Authorised by the Council to sign in that behalf



25150

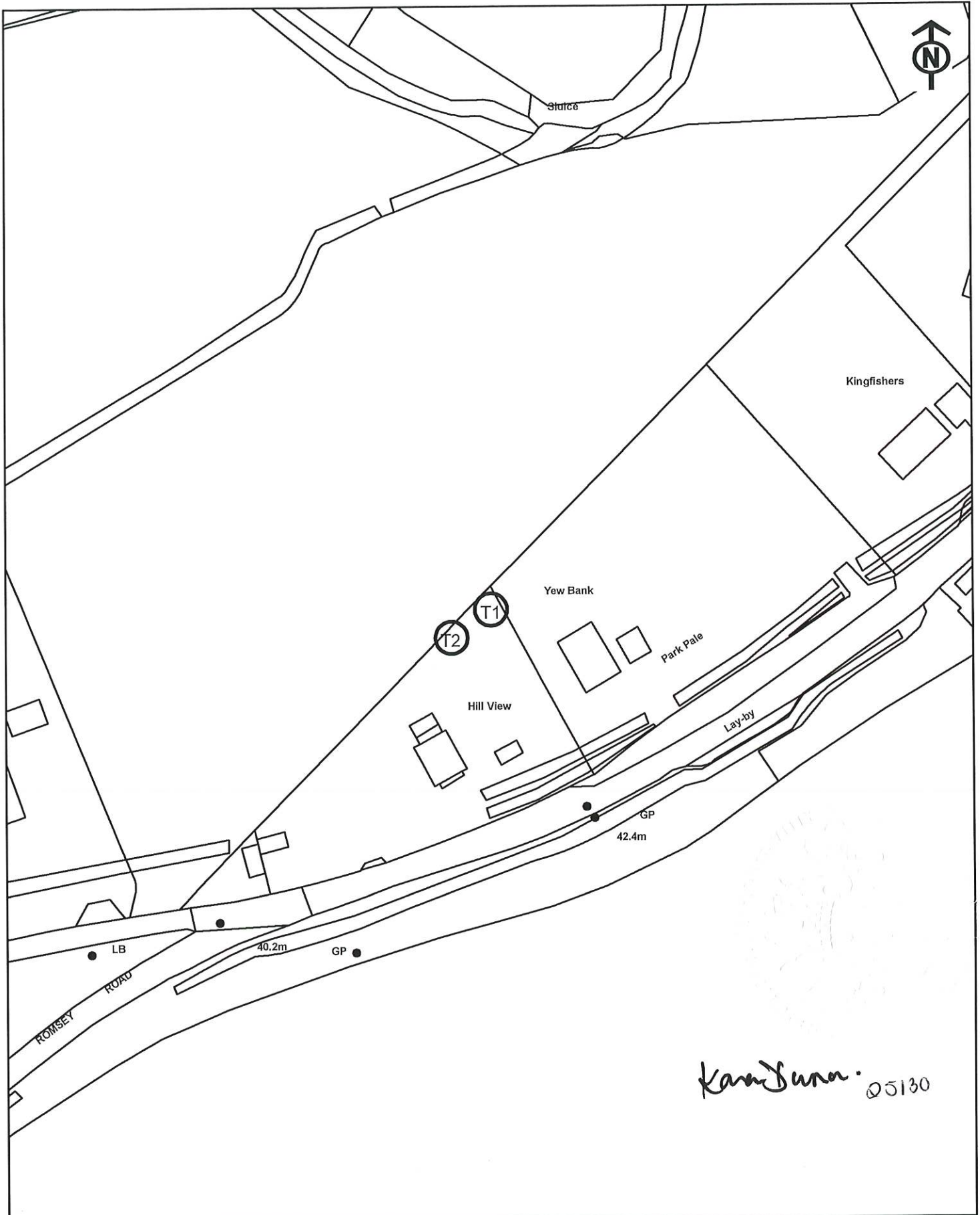

*Kan Suna* 05130

Tree	Area
Group	Woodland

**TOWN AND COUNTRY PLANNING ACT 1990**  
 Section 198-201

**TREE PRESERVATION ORDER TVBC 1245**  
 Location: Hill View, Romsey Road, Kings Somborne  
 Stockbridge Hampshire SO20 6PR

OS Grid:                      SCALE: 1:1250                      DATE: APRIL 2022                      DRAWING No: 1

**Test Valley**  
 Borough Council

HEAD OF PLANNING AND BUILDING  
 BEECH HURST: WEYHILL ROAD  
 ANDOVER: HAMPSHIRE: SP10 3AJ  
 Tel: 01264 398000